

EVENTS



Foundling
Museum





Creative action, transforming lives

Located in the heart of leafy Bloomsbury and overlooking Brunswick Square, the Foundling Museum can be exclusively yours for a memorable event. From lively drinks receptions and elegant dinner parties, to focused meetings and away days, the Museum blends historic grandeur with contemporary design.

We present the story of the Foundling Hospital, the UK's first children's charity and public art gallery. Founded in 1739 by the campaigner Thomas Coram, it was an innovative home for children whose mothers couldn't care for them, supported by leading artists including William Hogarth, George Frideric Handel and Charles Dickens. Their compassion and generosity show that art transforms lives. Inspired by our 300-year history of social change, today we work with outstanding contemporary artists, writers and musicians to deliver ambitious projects for young people and marginalised groups.

Situated within a Grade II-listed, Georgian-style building, the Museum houses a wealth of treasures, including Handel's will and paintings by William Hogarth, alongside works of art by leading contemporary artists.

As a registered charity, all income from venue hire supports our work with marginalised and vulnerable children.



OUR SPACES CAN BE HIRED FOR:

- Weddings
- Gala dinners
- Drinks receptions
- Award ceremonies
- Bar/Bat mitzvahs
- Silk parties
- Away days
- Conferences
- Filming & photography
- Product launches





Receptions & Dinners

Create lasting memories with an event at the Foundling Museum. We have a range of elegant spaces for receptions and dinners.

Welcome your guests with a drinks reception in the Court Room Gallery with its striking Rococo interior. Alternatively, treat your guests to dinner in the Picture Gallery, surrounded by magnificent paintings by celebrated artists including William Hogarth.

Elevate the experience by having an expert speaker bring the moving history of the Foundling Hospital and its compelling stories of love, loss and care to life.



HIRE PRICES

Evening hire, 4 hours from 6pm-10pm/7pm-11pm:

Court Room (40 seated, 80 standing):
£3,000+VAT

Picture Gallery (100 seated, 150 standing):
£4,000+VAT

Exclusive hire of whole Museum: £5,000+VAT

Additional hour: £800+VAT.

Please ask for our discount for registered charities.





Weddings & Life Celebrations

Whether you are looking to take your wedding vows or celebrate the life of a loved one, mark your special day with us at the Foundling Museum.

The Court Room Gallery boasts one of the finest original Rococo interiors in London, providing a peaceful and intimate atmosphere for reflection and remembrance. Or for a glamorous reception, look no further than the Picture Gallery, adorned with antique furnishings, large-scale portraits and an impressive marble fireplace.

Shake things up and dance the night away in the Study Studio, featuring a striking graphic mural by award-winning poet Lemn Sissay OBE.

With exclusive hire, the Museum can be your historic London home for the day. Plus, our dedicated team is here to make your event planning journey effortless.

Prices start from £2,000+VAT.

Please contact us for a quote:
events@foundlingmuseum.org.uk



'The Foundling Museum was the perfect backdrop for our cocktail hour and reception. The stunning mix of art and architecture truly worked so well with our table decor, flowers and day in general. It is such a special venue that has provided us with memories that will last a lifetime. The added lifetime membership was a lovely post-event touch that we will cherish. A big thank you to the team at the Museum for all their help in making our day great.'

Daniel & Jonny



Daytime Events

We have a choice of considered contemporary options. Our Clore Creative Studio is a bright contemporary space designed by award-winning architecture practice Jestico & Whiles. Or choose the Study Studio, a multipurpose space decorated with a thought-provoking mural by poet Lemn Sissay OBE featuring some of the world's favourite fictional characters including Harry Potter, Han Solo and Cinderella. Perfect for generating new ideas.

Our studio meeting spaces come fully AV and Wi-Fi equipped, and catering is available for all options on request. Your booking will even include free access to the Museum's collection when we're open to the public and guided tours can be arranged.

For a more classical approach, our historic rooms are available for daytime hire offering a beautiful setting for a larger meeting or conference.

We also have options to end the day with a reception or dinner in one of our elegant historic rooms.

Dry hire rates start from £895+VAT for a full day and catered packages start from £49pp for 50 people. Contact us for a quote: events@foundlingmuseum.org.uk



Filming & Photography

With an accessible location just 10 minutes from King's Cross St Pancras and the Euston Road, and situated in the heart of one of London's busiest filming boroughs, the Foundling Museum offers beautiful, spacious historic rooms.

Our spaces include the Court Room Gallery with its sumptuous Rococo interior, the Picture Gallery with its elegant 18th and 19th-century art masterpieces, a sweeping staircase with period features, through to the contemporary Clore Creative Studio and more. Lift access is available together with off-street parking.



The Museum offers multiple, flexible filming spaces across all genres including:

- Television interviews & dramas
- Feature films
- Documentaries
- Music videos
- Fashion & magazine shoots
- Commercials... and much more

Make an enquiry:
kim@kimhallettconsulting.co.uk
+44 (0)7920517965



Approved Suppliers

From caterers, florists and production companies, to musicians and photographers, our suppliers will be delighted to talk you through options. We can also recommend a selection of wedding planners.

As a Grade II-listed building, we kindly request you work with our approved suppliers for catering, production and flowers. Our suppliers have been carefully selected for their expert knowledge and familiarity with the Museum, as well as their ability to cater for a variety of styles and budgets. You are welcome to source your own photographers, DJs and musicians.

If you would prefer to use an unapproved caterer, florist or production company we can discuss working with them so long as they meet the Museum's terms and conditions.

See our website for details of our approved suppliers: foundlingmuseum.org.uk/venue-hire



Add On: Talks & Tours

Enhance your event and bring the incredible stories from the Foundling Museum to life with a tour by one of our expert guides. Choose from a range of subjects including the work of artists William Hogarth and Thomas Gainsborough, and the award-winning Gerald Coke Handel Collection which includes one of the Museum's most treasured possessions, Handel's will.

Guided Tour:
£80+VAT per tour

Gerald Coke Handel Collection Tour:
£200+VAT per tour

Curator Tour:
£300+VAT per tour
30 minutes for up to 20 people per tour



Room Capacities

COURT ROOM GALLERY

Seated dinner: 40
Standing: 80
Theatre style / Ceremony: 50
Boardroom: 21
U-shape: 24
Classroom: 24

PICTURE GALLERY

Seated dinner: 100
Standing: 150
Theatre style / Ceremony: 100
Boardroom: 28
U-shape: 30
Classroom: 36

STUDY STUDIO

U-shape: 23
Classroom: 36
Boardroom: 28
Theatre style: 50
Cabaret: 24

CLORE CREATIVE STUDIO

U-shape: 23
Theatre style: 65
Classroom: 36
Cabaret: 24
Boardroom: 28

WHOLE MUSEUM: 250

LOWER GROUND FLOOR

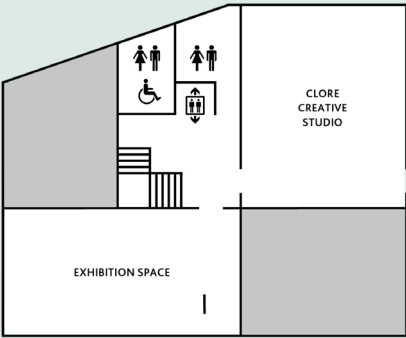

GROUND FLOOR

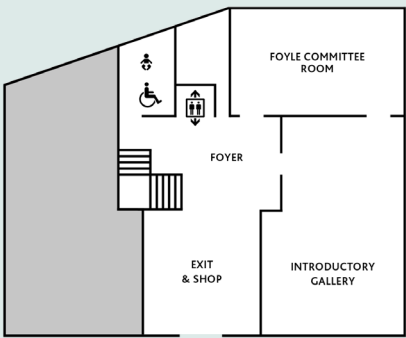

FIRST FLOOR

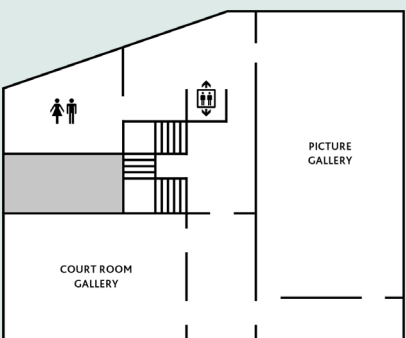

SECOND FLOOR

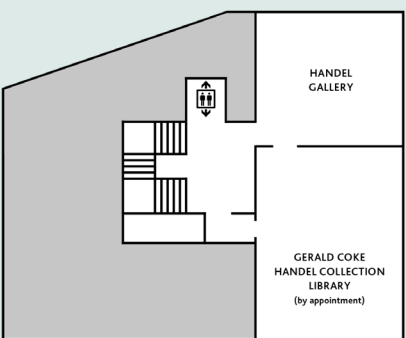

Please get in touch with us to book a visit.
events@foundlingmuseum.org.uk
+44 (0)20 7841 3616

More information and inspiration can be found at:
foundlingmuseum.org.uk/venue-hire

Foundling Museum
40 Brunswick Square
London
WC1N 1AZ

HOW TO GET HERE

Tube

The nearest tube station is Russell Square which is a four minute walk from the Museum.

Rail

The nearest train stations are King's Cross St Pancras and Euston.

Bus

Bus routes 1, 68, 91 and N91 all stop at Russell Square Station.

Parking

There is an NCP carpark located at The Brunswick Shopping Centre.

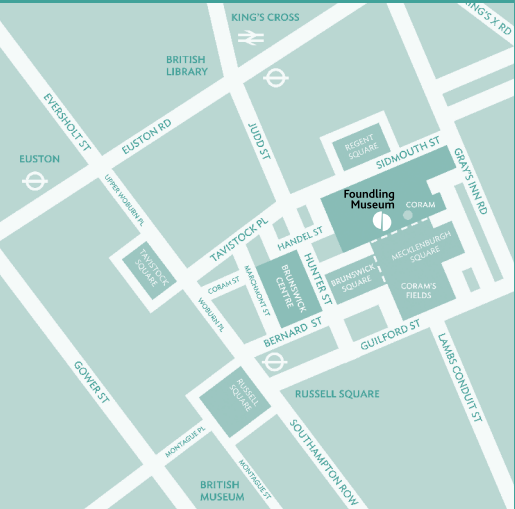

Image credits:
Mark Bothwell
Richard Gray
GG Archard
Emile Holba
Antony Jones
Diana Gomez
Rachel Cherry
Will Scott
Fernando Manoso

